

NIGHT MARKETS  
— & —  
FOOD COURT





NIGHT MARKETS  
— & —  
FOOD COURT

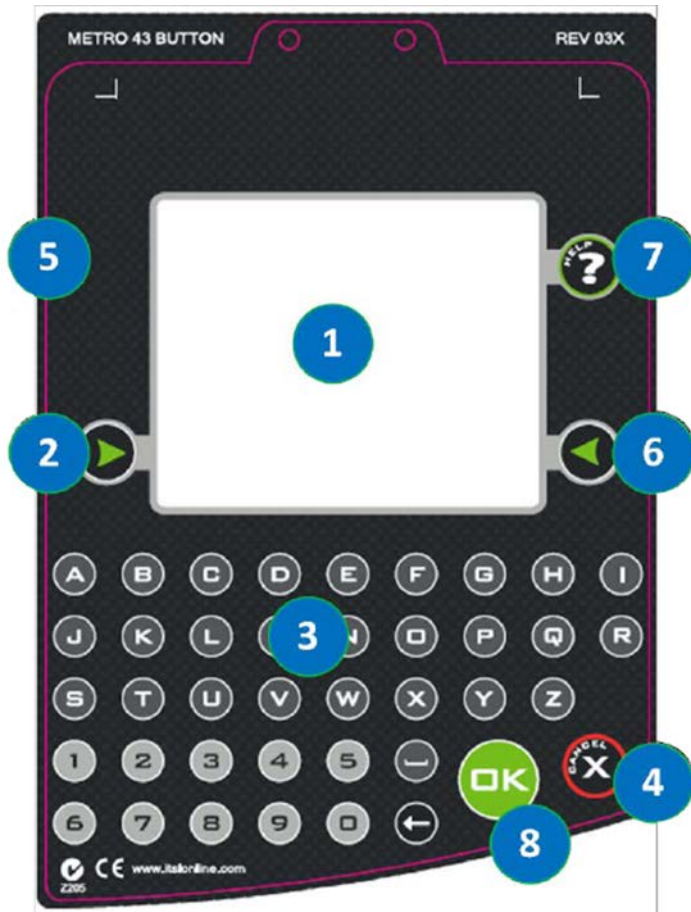

# Cairns Night Markets

## Using the Alpha Numeric Keypad



1. Screen (LCD) displays information to users
2. Left Arrow button  selects the option shown in the lower left corner of the screen
3. Alphanumeric keypad allows users to enter a Vehicle Registration number
4. Cancel button  cancels a transaction or other process
5. Not used
6. Right Arrow button  selects the option shown in the lower right corner of the screen
7. Help button  displays instructions
8. OK button  lets users proceed with the selected option or respond positively to an onscreen prompt

# How to cancel your transaction

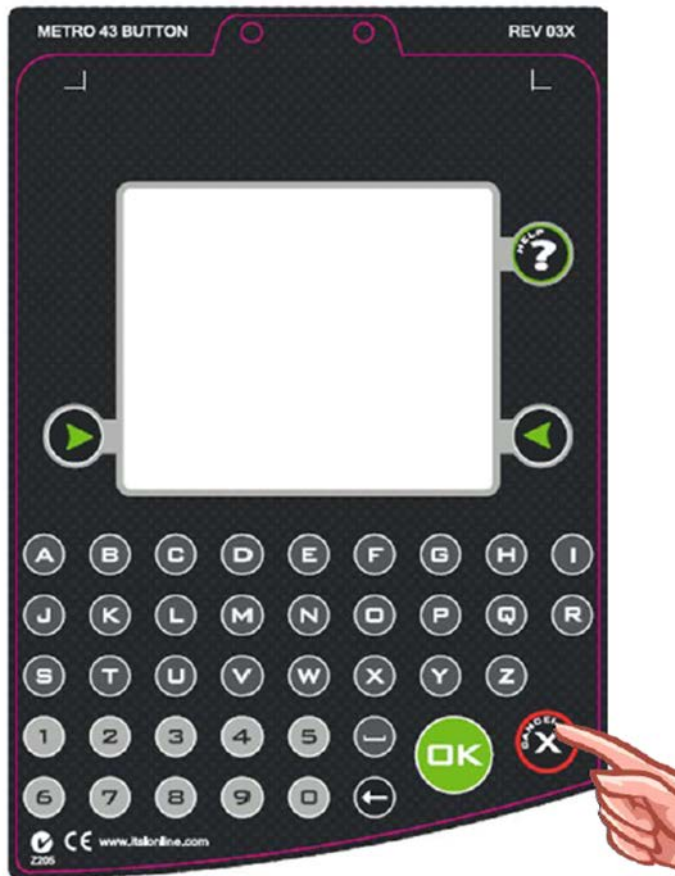

- You can cancel your transaction at any time by pressing the  cancel button
- Any coins already inserted will be returned to the reject tray

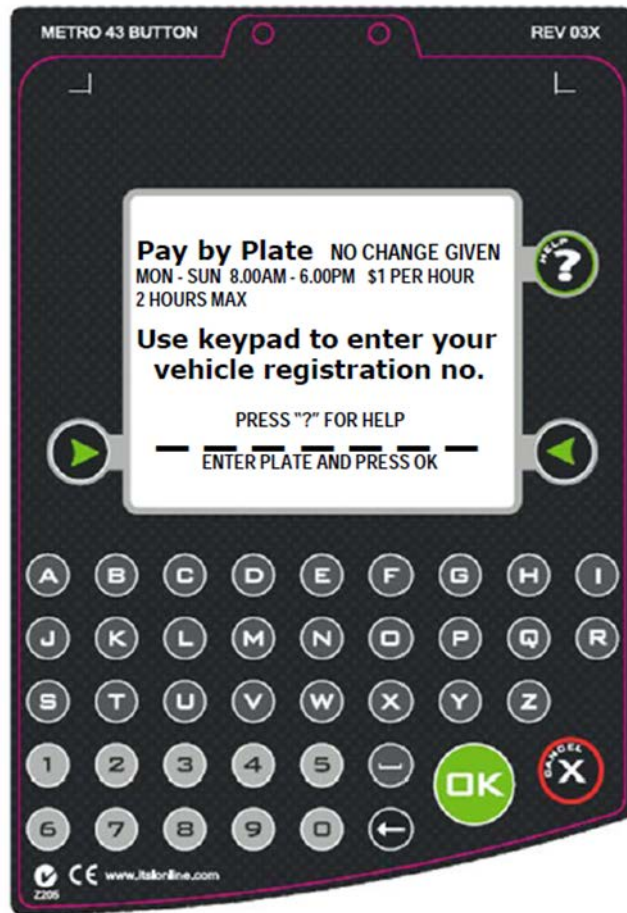

# Using Pay by Plate Parking Meters

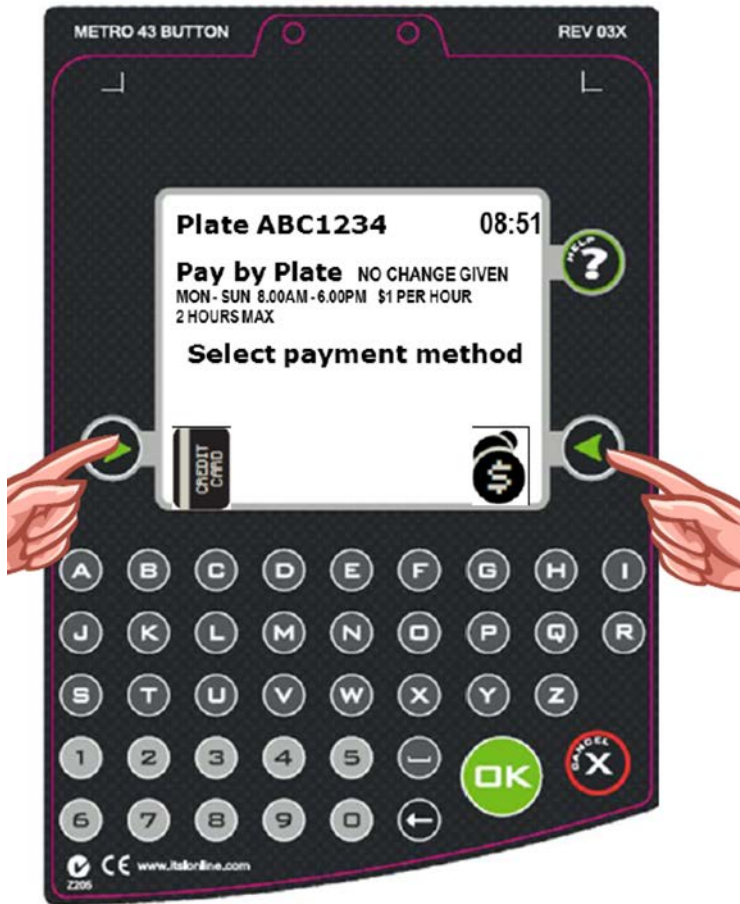

- You will be prompted to enter your vehicle's registration number, using the alpha numeric keypad
- When correct press **OK** to continue

# Payment Methods



- If using coins press the Right Hand Arrow  or simply place coins in the coin slot
- For Credit Card payment press the Left Hand Arrow 

# Paying with coins

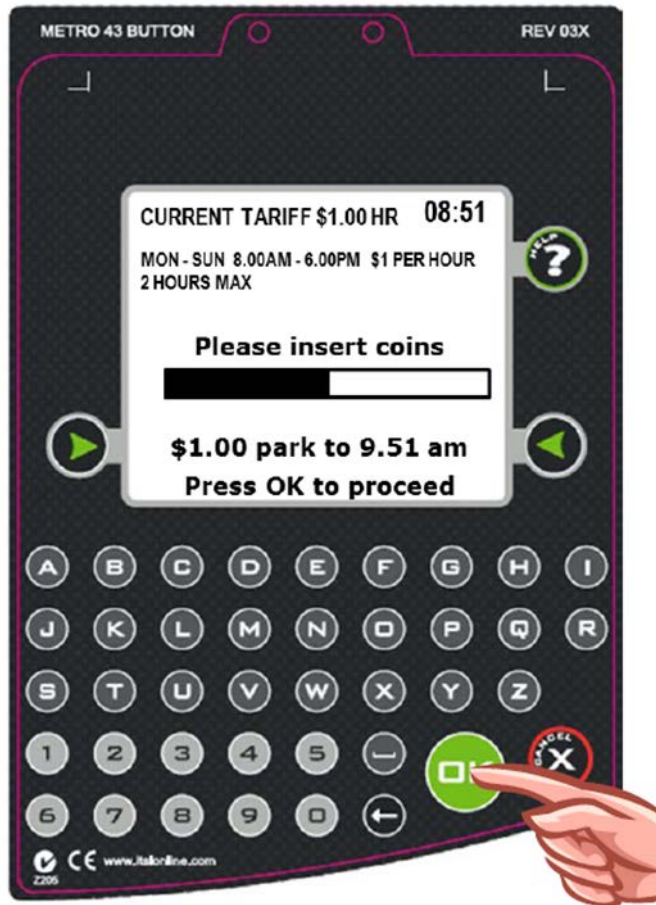

- Insert Coins into the meter's coin slot
- The screen will display the amount paid and show the time period in the gauge
- Continue adding coins until you have paid for the time that you need or reached the maximum time limit that applies
- Press  to complete the transaction



# Paying with Credit Card

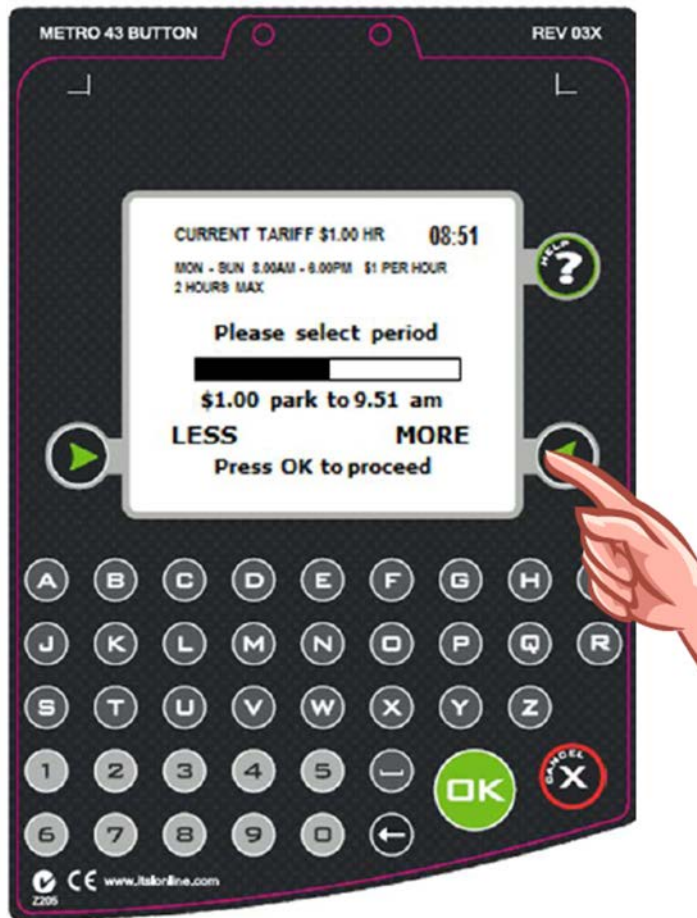

- Press Left Hand Arrow  button to select Card Payment
- If the credit card service is not available only the coin icon will be displayed

# Paying with Credit Card



- Select the required parking period using the Right Arrow button  to increase the time to a maximum of **2-weeks** and the Left Arrow button  to decrease the time
- When the corresponding value charged meets your requirements press OK  to proceed
- A maximum time limit of **2-weeks** will apply using this method



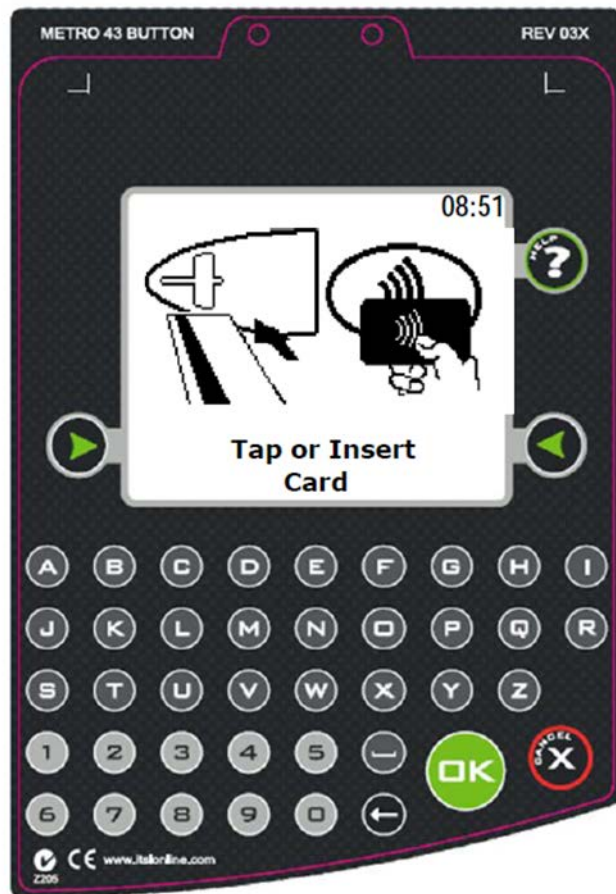

# Paying with Credit Card

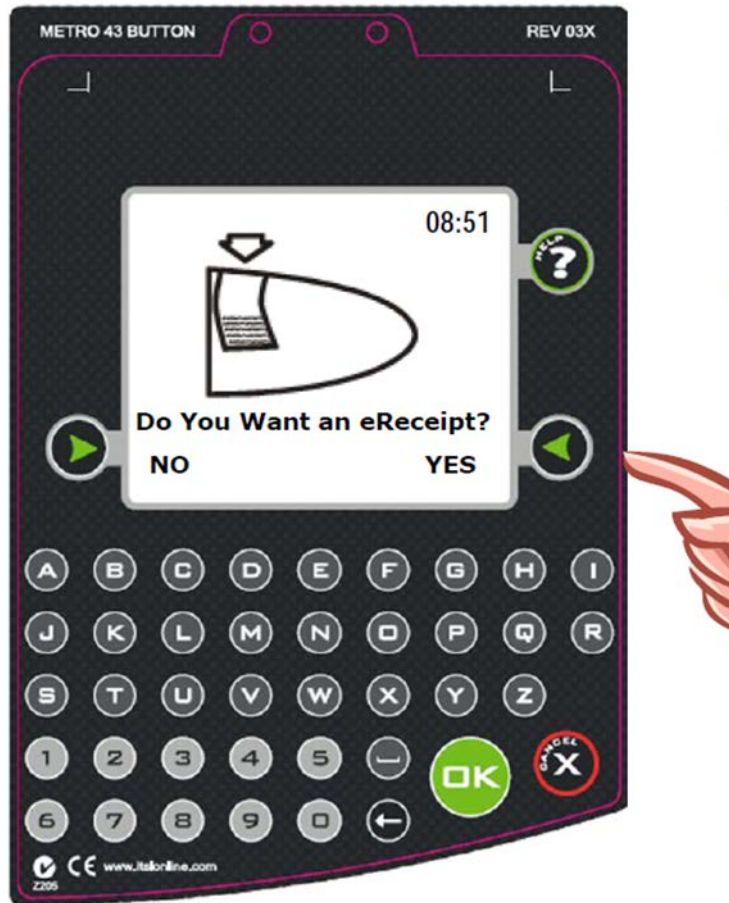

- Present your Credit Card by either inserting in the card reader or Wave/Tap across the scanner 
- When the card has been read, you will be prompted to remove it
- If your card cannot be read, you will be prompted to reinsert or wave/tap it again

# Electronic Receipts



- The Pay by Plate parking meter has an option for an electronic receipt
- If you require an electronic receipt press the Right Arrow button  for the YES option

# Electronic Receipts

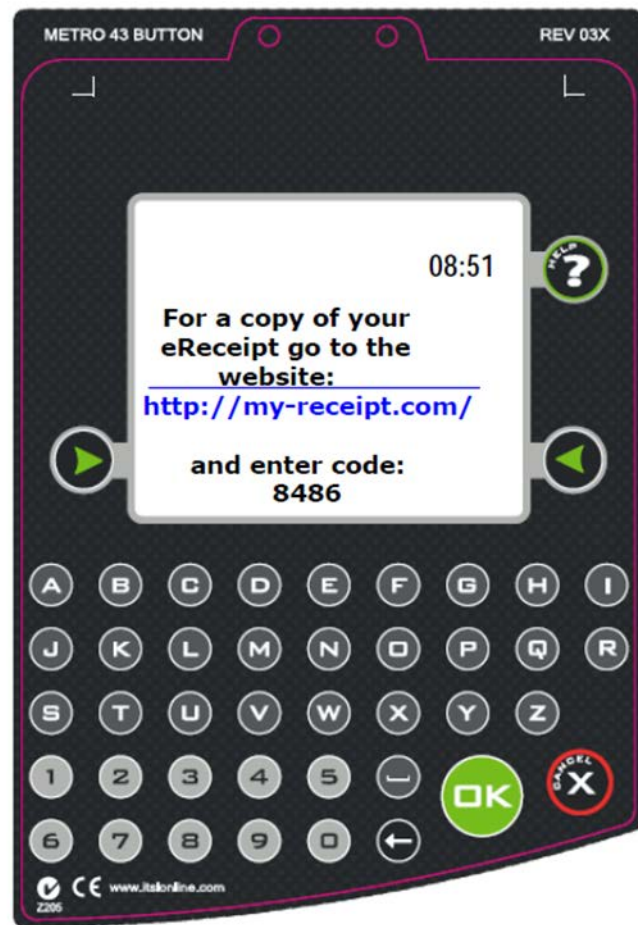

- Take note of the 4 digit code displayed and the web address - you may wish to take a photo of the screen
- Go to <http://my-receipt.com> and enter your code and vehicle registration number to retrieve your receipt

# Further information

Instructional video is available at:

- eReceipt option at the meter

<https://youtu.be/B4y7DvAb4lw>

- how to retrieve eReceipt from the website:

<https://youtu.be/P3L8iWH0ERo>

